

# SWEPAC

RDH 760 L  
RDH 760 Z

---

## USER MANUAL



## CONTENTS

SAFETY INSTRUCTIONS.....	3
OPERATION, PRECAUTIONS.....	3, 4, 5, 6
TRANSPORT, PRECAUTIONS.....	6
MAINTENANCE, PRECAUTIONS.....	6
TECHNICAL DATA.....	7
DIMENSION.....	7,8
SIGNS.....	9, 10
MACHINE SIGNS .....	11
DESCRIPTION.....	12
OPERATION.....	13
TO START (LOMBARDININ ENGINE).....	14
TO START (HATZ ENGINE).....	15,16, 17, 18
SWITCHING OFF THE ENGINE (MECHANICALLY).....	18
OPERATION.....	19, 20
OPERATING NEAR EDGER.....	20
MAINTENANCE.....	21
SCRAPER, LUBRICATION; AIR CLEANER.....	22
HYDRAULIC SYSTEM.....	22
TROUBLESHOOTING.....	23
EC-DECLARATION OF CONFORMITY.....	24

## SAFETY INSTRUCTIONS

To reduce the risk of serious injury or death to yourself or others read and understand the Safety and operating instruction before installing, operating, repairing, maintaining, or changing accessories on the machine.

Post this Safety and operating instruction at work locations, provide copies to employees, and make sure that everyone reads the Safety and operating instruction before operating or servicing the machine.

In addition, the operator or the operator's employer must assess the specific risks that maybe present as a result of each use of the machine.

Additional instructions for the engine can be found in the manufacturer's engine manual.

### Personal precautions and qualifications

*Only qualified and trained persons should operate or maintain the machine. They must be physically able to handle the bulk-weight, and power of the machine.*

*Always use your common sense and good judgement.*

### Personal protective equipment

*Always use approved protective equipment. Operators and all other persons in the working area must wear personal protective equipment that includes:*

- *Protective helmet*
- *Hearing protection*
- *Impact resistant eye protection with side protection*
- *Respiratory protection if required*
- *Protective gloves*
- *Proper protective boots*
- *Appropriate work overall or similar clothing (not loose-fitting) that covers your arms and legs.*

### Drugs, alcohol or medication

Drugs, alcohol or medication may impair your judgment and power of concentration. Poor reactions and incorrect assessment can lead to severe accident or death.

Never use the machine when you are tired or under the influence of drugs, alcohol or medication.

## OPERATION, PRECAUTIONS

### DANGER Explosion hazard

*If a warm machine or exhaust pipe comes into contact with explosives, an explosion could occur. During operating with certain materials, sparks and ignition can occur. Explosions will lead to severe injuries or death.*

*Never operate the machine in any explosive environment.*

*Never use the machine near flammable materials, fumes or dust.*

*Make sure that there are no undetected sources of gas or explosives.*

*Avoid contact with the warm exhaust pipe or the bottom of the machine*

### DANGER Fire hazard

If a fire starts in the machine, it can cause injury.

If possible, use an ABE-class powder extinguisher, otherwise use a BE-type carbon dioxide fire extinguisher.

### DANGER Fuel hazard

*The fuel is flammable and fuel fumes can explode when ignited, causing serious injury or death.*

*Protect your skin from contact with the fuel. If fuel has penetrated into the skin, consult a qualified health professional.*

*Never remove the filler cap or fill the fuel tank when the machine is hot.*

*Fill the fuel tank in outdoors or in a clean and well-ventilated place, free from sparks and open flames. Fill the fuel tank at least ten meters (30 feet) from the place where the machine has to be used.*

*Release the filler cap slowly to let pressure escape.*

*Never over fill the fuel tank.*

*When the machine is in use, make sure that the filler cap is well seated and tightened.*

*Avoid spilling the fuel on machine, wipe off any spilled fuel.*

*Check regularly for fuel leakages. Never use the machine if there is a fuel leakage.*

*Never use the machine in the proximity of material that can generate spark. Remove all hot or spark-generating devices before starting the machine.*

Never smoke while refilling the fuel tank or when working with the machine or servicing it.

Only store fuel in a container that is specially constructed and approved for that purpose.

Consumed fuel and oil containers must be taken care of and returned to the retailer.

Never use your fingers to check for fluid leakages.

### **WARNING Unexpected movements**

*The machine is exposed to heavy strains during operation. If the machine breaks or gets stuck, there might be a sudden and unexpected movement that can cause injuries.*

*Always inspect the machine prior to use. Never use the machine if you suspect that it is damaged.*

*Make sure that the handle is clean and free of grease and oil.*

*Keep your feet away from the machine. Never sit on the machine.*

*Never strike or abuse the machine.*

*Pay attention and look at what you are doing.*

### **WARNING Dust and fume hazard**

*Dusts and /or fumes generated or dispersed when using the machine may cause serious and permanent respiratory disease, illness, or other bodily injury. Some dusts and fumes created by compaction work contains substances known to cause respiratory diseases, cancer, birth defects, or other reproductive problems.*

*Dust and fumes in the air can be invisible to the naked eye, so do not rely on eye sight to determine if there is dust or fumes in the air.*

*To reduce the risk of exposure to dust and fumes, do all of the following:*

*Perform site-specific risk assessment. The risk assessment should include dust and fumes created by the use of the machine and the potential for disturbing existing dust.*

*Wear, maintain and correctly use respiratory protection as instructed by your employer and as required by occupational health and safety regulations. The respiratory protection must be effective for the type of substance dust contains (if applicable, approved by relevant governmental authority).*

Work in a well-ventilated area.

If the machine has an exhaust, direct the exhaust so as to reduce disturbance of dust in a dust filled environment.

Operate and maintain the machine as recommended in the operating and safety instructions.

Wear washable or disposable protective clothes at the worksite. Have a shower and change with clean clothes before leaving the work site to

reduce exposure of dust and fumes to yourself and others in the vehicle, at home or other areas.

Avoid eating, drinking, and using tobacco products in areas where there is dust or fumes.

Wash your hands and face thoroughly as soon as possible upon leaving the site, and always before eating, drinking, using tobacco products, or making contact with other persons.

Including the "Occupational Health & Safety Regulations", comply with all applicable laws and regulations of the local country.

Participate in air monitoring, medical examination programs, and health and safety training programs provided by your employer or trade organizations and in accordance with occupational health and safety regulations and recommendations. Consult with physicians experienced in relevant occupational medicine.

Work with your employer and trade organization to reduce dust and fume exposure at the work site and to reduce the risks. Effective health and safety programs, policies and procedures for protecting

workers and others against harmful exposure to dust and fumes should be established and implemented based on advice from health and safety experts.

Consult with experts.

### **DANGER Exhaust gas hazard**

*The exhaust gas from the machine's combustion engine contains carbon monoxide which is poisonous and have chemicals which may cause cancer, birth defects, or other reproductive problems. Inhalation of exhaust fumes can cause serious injury, illness, or death.*

*Never inhale exhaust fumes.*

*Ensure good ventilation (extraction of air by fan if necessary).*

**WARNING Projectiles**

*Failure of the work piece, or even accessories of the machine itself may generate high velocity projectiles. During the operation, splinters or other particles from the compacted material may become projectile and cause personal injury by striking the operator or other persons.*

*To reduce these risks:*

*Use approved personal protective equipment and safety helmet, including impact resistant eye protection with side protection.*

*Make sure that no unauthorized persons trespass into the working zone.*

*Keep the work place free from foreign objects.*

**WARNING Rotating drums hazards**

*There is a risk of hands and feet getting trapped under the rotating and vibrating drums when the machine is running. This can cause personal injury.*

*Never place your hands or feet anywhere closer to the roller drums when the machine is running*

**WARNING Motions hazards**

*When using the machine to perform work-related activities, you may experience discomfort in the hands, arms, shoulders, neck, or other parts of the body.*

*Adopt a comfortable posture whilst maintaining secure footing and avoid awkward off-balanced postures.*

*Changing posture during extended tasks may help avoid discomfort and fatigue.*

*In case of persistent or recurring symptoms, consult a qualified health professional.*

**WARNING Vibrations hazards**

*Normal and proper use of the machine exposes the operator to vibration. Regular and frequent exposure to vibration may cause, contribute to or aggravate injury or disorders to the operator's fingers, hands, wrists, arms, shoulders and/or nerves and blood supply or other body parts, including debilitating and/or permanent injuries or disorders that may develop gradually over periods of weeks, months, or years. Such injuries or disorders may include damage to the blood circulatory system, damage to the nervous system, damage to joints, and possibly damage to other body parts.*

*Operate and maintain the machine as recommended in this instruction manual, to prevent an unnecessary increase in the vibration.*

*The following may help to reduce exposure to vibration for the operator:*

*Make sure that the machine is well-maintained and not worn out.*

*Immediately stop working if the machine suddenly starts to vibrate strongly. Before resuming the work, find and remove the cause of the increased vibrations.*

*Participate in health surveillance or monitoring, medical exams and training programs offered by your employer and when required by law.*

*When working in cold conditions wear warm clothing and keep hands warm and dry.*

*See the "Noise and vibration specification" for the machine. This information can be found on the page 10.*



**WARNING Trapping hazards**

*There is a risk of neck ware, hair, gloves, and clothes getting dragged into or caught by rotating machine parts. This may cause choking, scalping, lacerations, or death.*

*To reduce the risk:*

*Never grab or touch a rotating machine part.*

*Avoid wearing clothing, neck ware or gloves that may get caught.*

*Cover long hair with a hairnet.*

**DANGER Electrical hazard**

*The machine is not electrically insulated. If the machine comes into contact with electricity this may result in serious injuries or death.*

Never operate the machine near any electric wire or other source of electricity.

Make sure that there are no concealed wires or other sources of electricity in the working area.

**DANGER Concealed object hazard**

*While operating, concealed wires and pipes constitute a danger that can result in serious injury.*

Check the composition of the material before operating.

Watch out for concealed cables and pipes,

For example: Electricity, telephone, water, gas, and sewage lines.

If the machine seems to have hit a concealed object, switch off the machine immediately.

Make sure that there is no any danger before continuing the operation.

**WARNING Involuntary start**

*Involuntary start of the machine may cause injury.*

Keep your hands away from the start and stop device until you are ready to start the machine.

Learn how the machine is switched off in the event of an emergency.

**WARNING Noise hazard**

*High noise levels can cause permanent hearing loss and other problems such as tinnitus (ringing, buzzing, whistling, or humming in the ears).*

Risk assessment of these hazards and implementation of appropriate controls is essential.

Operate and maintain the machine as recommended in these instructions.

If the machine has a silencer, check that it is in place and in good working condition.

Always use hearing protection.

**TRANSPORT, PRECAUTIONS****WARNING Loading and unloading hazard**

*When the machine is lifted by a crane and similar appliance, this can lead to injury.*

*Use marked lifting points.*

*Make sure that all lifting devices are dimensioned for the weight of the machine.*

*Never remain under or in the immediate vicinity of the machine.*

**MAINTENANCE, PRECAUTIONS****WARNING Unexpected start hazard**

*During maintenance or when changing any parts like scrapper etc. on the machine, there is a risk that the engine backfires or that the machine unexpectedly starts. This applies especially when the engine is hot and if the engine power switch/ key is in "ON" position. This can result in serious personal injury.*

Always let the engine cool down.

Always turn the engine ignition key to "OFF" position.

Always remove the key from the ignition.

**WARNING Unexpected start hazard**

*Any machine modification may result in bodily injuries to yourself or others.*

*Never modify the machine. Modified machines are not covered by warranty or product liability.*

*Always use original parts, insertion tools, and accessories.*

*Change damaged parts immediately.*

*Replace worn components in good time.*

**CAUTION High temperature**

*The machine's engine exhaust pipe, and bottom become hot during operation. Touching them can lead to burns.*

Never touch a hot machine.

Never touch the bottom of the machine when its hot.

Wait until the engine, exhaust pipe, and bottom of the machine have cooled down before carrying out maintenance work.

**STORAGE, PRECAUTIONS**

Keep the machine in a safe place, out of the reach of children and locked up.

## TECHNICAL DATA

### RDH 760 L

Engine type.....Lombardini Kohler 15 LD 440  
 Engine output.....8,1 kW  
 Operating weight.....732 kg  
 Drum Diameter .....650xØ404 mm  
 Static Linear Force.....54 N/cm  
 Centrifugal Force .....21 kN  
 Frequency .....3300 Vpm (55 Hz)  
 Travel Speed .....0-3.6 Km/h  
 Water tank Capacity.....65 L  
 Hydraulic Fluid type.....SAE L-HM46  
 Hydraulic Fluid Capacity.....14 L  
 Engine Oil Type.....SAE 15W40 CD  
 Engine Oil Volume.....1,5L  
 Vibrator Oil.....SAE15W40 SJ  
 Vibrator Oil Capacity.....0,6L  
 Fuel type.....Diesel

Sound Specification:

Guaranteed sound power level:.....108 dB (A)

Vibration Specification, for hand arm:.....5.0m/s<sup>2</sup> Value

### RDH 760 Z

Engine type.....Hatz 1 B 40  
 Engine output.....7,5 kW  
 Operating weight.....735 kg  
 Drum Diameter .....650xØ404 mm  
 Static Linear Force.....54 N/cm  
 Centrifugal Force .....21 kN  
 Frequency .....3300 Vpm (55 Hz)  
 Travel Speed .....0-3.6 Km/h  
 Water tank Capacity.....65 L  
 Hydraulic Fluid type.....SAE L-HM46  
 Hydraulic Fluid Capacity.....14 L  
 Engine Oil Type.....SAE 15W40 CD  
 Engine Oil Volume.....1,5L  
 Vibrator Oil.....SAE15W40 SJ  
 Vibrator Oil Capacity.....0,6L  
 Fuel type.....Diesel

Sound Specification:

Guaranteed sound power level:.....108 dB (A)

Vibration Specification, for hand arm:.....5.0m/s<sup>2</sup> Value

## Dimension

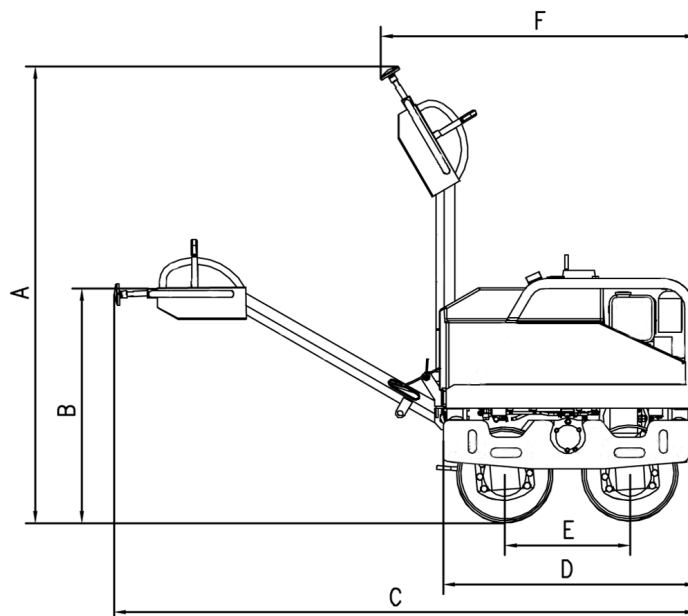

Ref.	Dimension (mm)
A	1900
B	990
C	2430
D	1100
E	520
F	1350

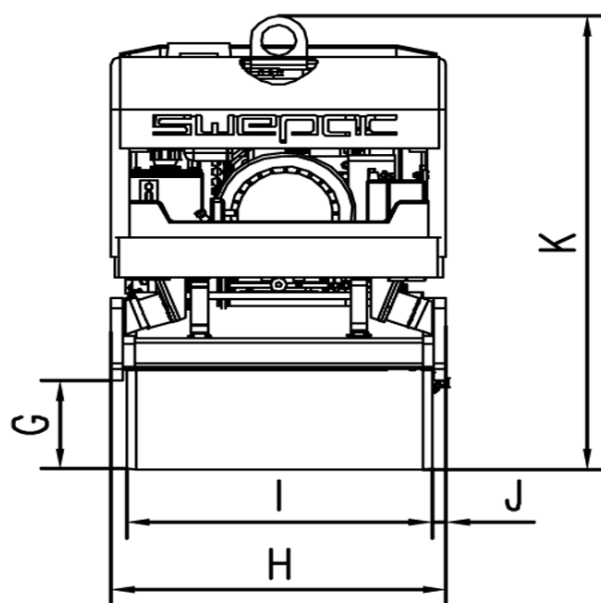

Ref.	Dimension (mm)
G	220
H	710
I	650
J	30
K	1130



## SIGNS

### Warning Signs

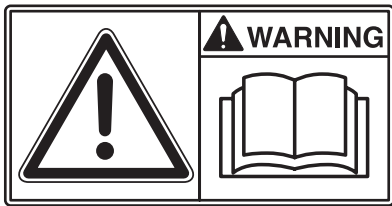

Before use, carefully read the manual and its safety instructions so that you can handle the machine safely. Ensure that the manual is always accessible.



Engine and silencer: To avoid burns or discomfort, do not touch hot engine parts when the engine is on or when the machine has recently been used.



Belt drive: Keep hands, tools and other objects away from the belt drive when the machine is on to avoid injury and damage. See the safety instructions in the manual.



As the sound pressure level at the operator's ears exceeds 80 dB (A), ear protectors must be used when working with the machine to prevent hearing damage.



**NOTE!** Use only the machine's lifting eye to lift the machine.



**NOTICE!**  
Throttle control lever:  
Turtle=Idle or slow,  
Rabbit=Full or fast

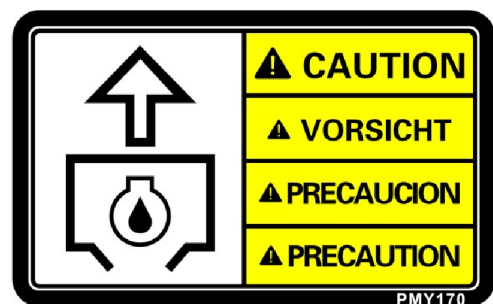

Engine oil drain.

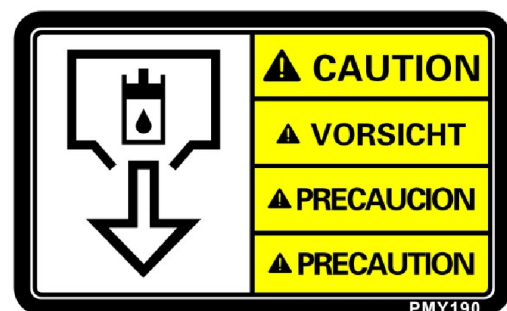

Hydraulic oil drain.

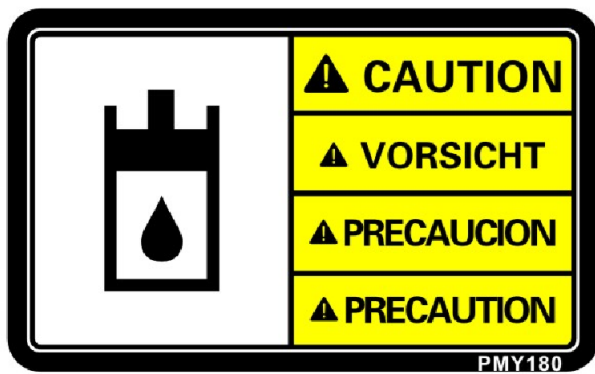

Hydraulic oil reservoir fill tube.

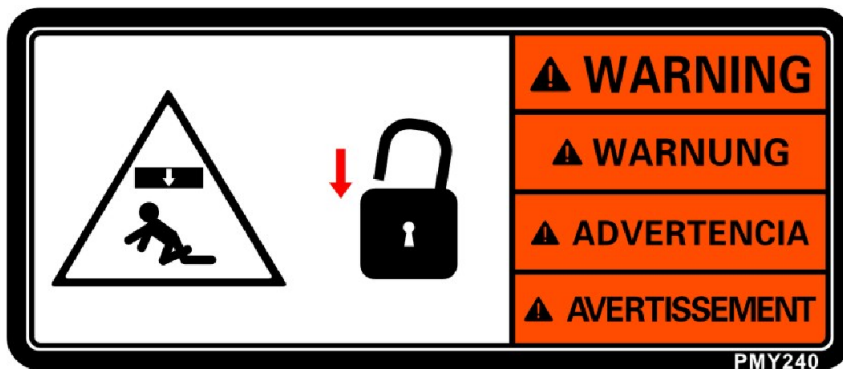

The handle must be locked when in the raised position.

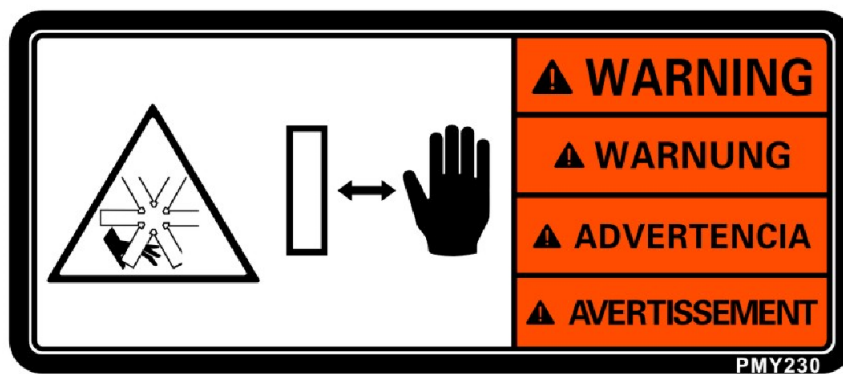

**WARNING!**  
Rotating engine components.  
Keep your hands at a safe distance from the danger zone.

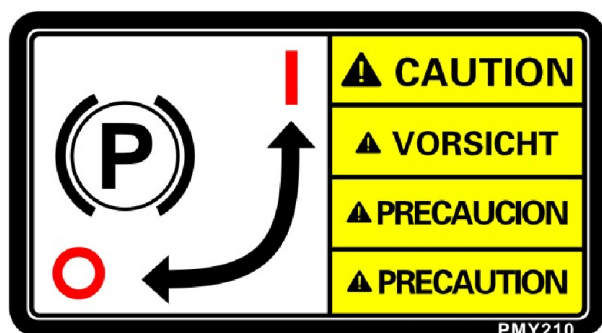

Parking brake.

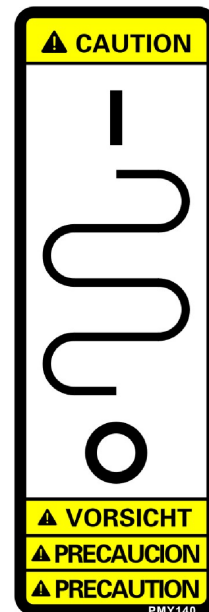

Vibration control On/Off.

## Machine Signs

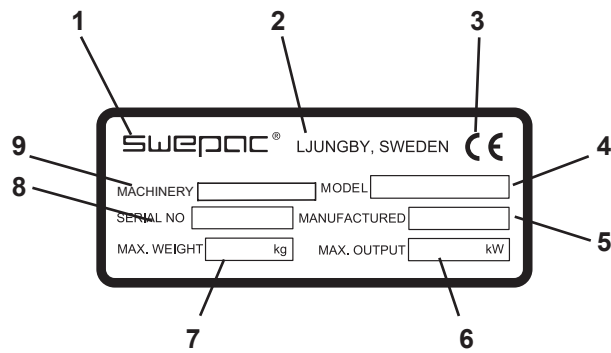

1. Manufacturer
2. Place, Country of manufacture.
3. CE mark.
4. Model name.
5. Year of manufacture.
6. Max. engine power.
7. Max. weight.
8. Serial number.
9. Machine type

## Description

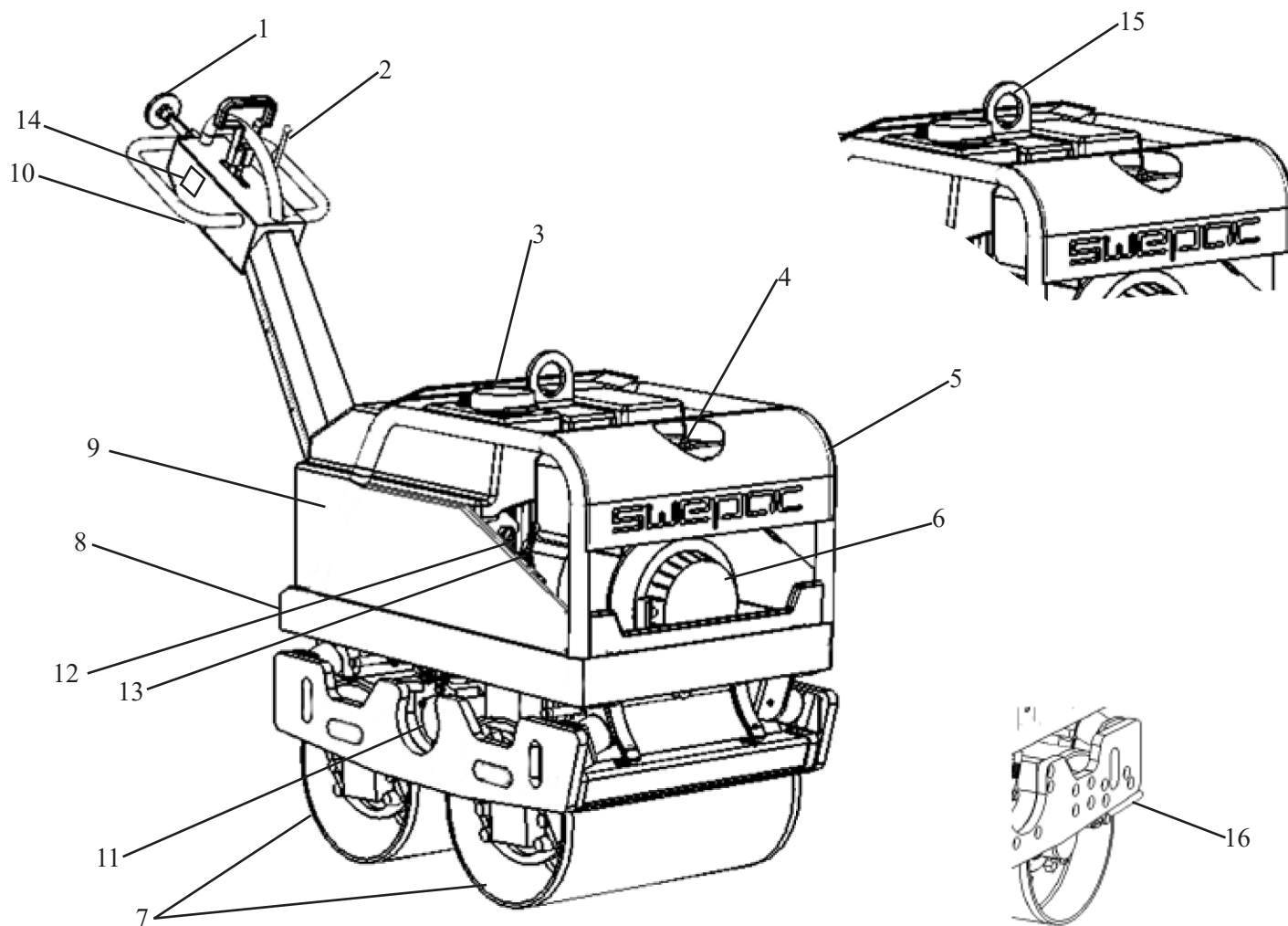

Ref.	Description
1	Push to Forward Bar
2	Lever for vibrator "ON-OFF "
3	Water tank filling
4	Refuelling
5	Protective frame
6	Hatz engine / Lombardini engine
7	Rollers
8	Chassis
9	Side cover
10	Operating handle
11	Water Drain Valve
12	Hydraulic oil level / Temperature gauge
13	Dipstick, Engine oil
14	Ignition key
15	Lifting eye
16	Parking brake

## OPERATION

### Operating Principle

The following instructions were compiled to provide you information on how to obtain long and trouble-free use of the machine. Periodic maintenance of the machine is essential. Read the manual carefully and thoroughly familiarize yourself with the machine and all its functions. Failure to do so may injure yourself or a bystanders.

### Delivery Checks

Immediately on taking delivery of your new machine and before putting it into service.

- Read the operation manual completely—it could save a great deal of unnecessary expenses.
- Read the engine manual supplied.
- Check the general condition of the machine – has it been damaged during delivery?
- Check engine oil level.
- Check fuel level.
- Hydraulic fluid level

Recommended lubricants are detailed in the Technical Data above.

### Before Starting

Before starting the machine, check the following items:

- All handles are free from grease, oil and dirt.
- All control levers are in the neutral position.
- All bolted joints are tightened.
- Fuel level
- Water tank level
- Oil level in the engine
- Hydraulic fluid level

**NOTICE:** Check the hydraulic fluid level and the oil level in the engine and eccentric element.  
The warranties are VOID if the machine is run without oil and hydraulic fluid.

## TO START (LOMBARDINI ENGINE)

### Warning lamps (LOMBARDINI)

There are three lamps: 1. Status "OK". 2. Low Engine Oil Pressure. 3. Battery Charging

After starting the machine, the OK must glow green and rest of the two lamps must turn off during the operation. If they don't turn off, stop the engine and check for the fault.



Before starting the machine must know the location and function of all controls.

1. Do not actuate starter for more than 20 seconds at a time. If engine does not start, wait 1 minute before repeating attempt. If engine does not start after two attempts, trace the cause according to Diagnosis Chart.

2. Key always in on position when engine is running. Make sure that all the warning lights are off when the engine is running. For engines with starting panel equipped with engine protection, make sure the OK light only keeps ON.

After starting the machine, run the engine at idle speed as per the table below:

Temperature °C	Time (Minutes)
0 / 20	5
-20 / -10	2
-10 / -5	1

### To Stop

1. Before stopping the engine, let it run at idle speed for a few minutes.
2. Keep all the operation levers in neutral position.

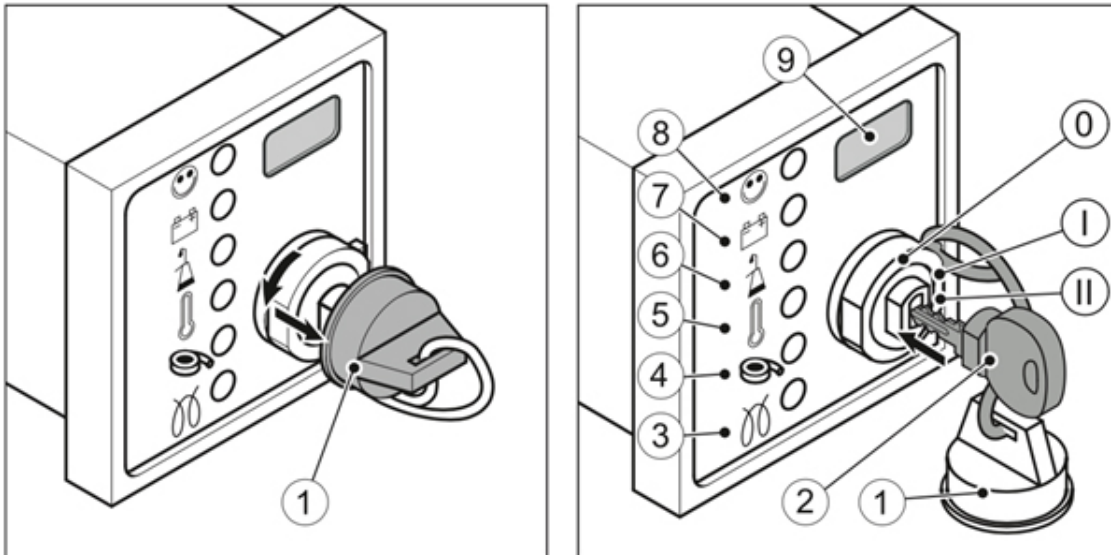

**TO START (HATZ ENGINE)****STARTING THE ENGINE WITH KEY****Overview – HATZ instrument Boxes**



1	Protective cap
2	Starting key
3	Pre glow display (option)
4	Air filter maintenance indicator (not activated)
5	Engine temperature display (option)
6	Oil pressure display
7	Charge control
8	Operating display
9	Operating hours counter (option)

Ignition lock	
0	Off
I	Operation
II	Start

## Indicator lamps

When the starting key is turned to position "I" various indicator lamps flash or light up (depending on the equipment version). If there is a fault, the applicable indicator does not go out after the engine start or it lights up again during operation.

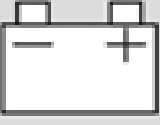
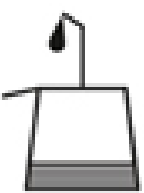
## Explanation of symbols

	<b>Operating display</b> Lights up during operation when there is no engine fault.
	<b>Charge control</b> Fault in the alternator or alternator charging circuit. The battery is no longer charged. Eliminate the fault immediately.
	<b>Oil pressure display</b> FSwitch off the engine immediately! Danger of engine damage. Check the oil level. Refer engine Manual. Contact Hatz service if the oil level is correct.
	<b>Engine temperature display</b> FSwitch off the engine immediately! Danger of engine damage. Engine temperature is impermissibly high. Refer Engine Manual.
	<b>Pre glow display</b> Lights at temperatures below 0°C. Start the engine when the display has gone out.

## OVERVIEW FUEL SHUT-OFF VALVE (OPTIONAL)

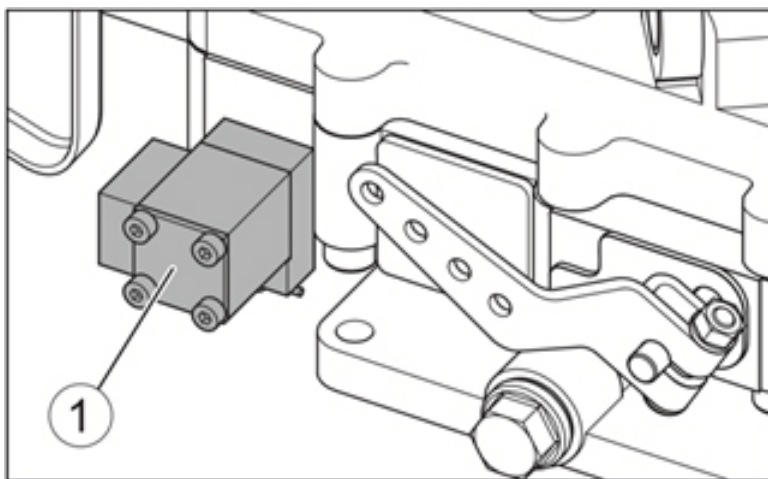

1. Fuel Shut-Off Valve (Optional)

## Description of functions

When the starting key is moved to position I the fuel shut-off valve (1) is electrically unlocked. The fuel supply to the injection pump is enabled, the engine is ready to start. When the engine is running, turning the starting key to position 0 locks the fuel shut-off valve and thereby blocks the fuel supply to the injection pump, the engine switches off. This fuel shut-off valve is also used in association with the electrical automatic shutoff. When faults occur, the automatic shutoff switches off the engine. For troubleshooting details, *Please refer Engine Manual*.

## NOTICE

	<ul style="list-style-type: none"> <li>▪ Start for max. 30 seconds. If the engine is still not running after that, turn the starting key back to position "0" and eliminate the cause (For troubleshooting refer engine manual.)</li> <li>▪ Turn the starting key to position "0" every time you want to start the engine.</li> <li>▪ The anti-repeat device in the ignition lock makes it impossible for the starter to engage while the engine is running and become damaged.</li> </ul>
---	--

STEP	ACTIVITY
1	Check the speed adjustment (Keep Throttle lever halfway).
2	Remove the protective cap (1) from the ignition lock.
3	Insert the starting key all the way and turn to position "I". When the pre glow display (3) lights up, wait until it goes out then continue with step 4.
4	Turn the starting key to position "II".
5	As soon as the engine is running, release the starting key. <ul style="list-style-type: none"> <li>▪ The starting key springs back to position "I" and remains in this position during operation.</li> <li>▪ The charge control (7) and oil pressure display (6) go out.</li> <li>▪ Operating display (8) lights up and signals there is no engine fault.</li> </ul>

### Emergency start:

If an electrical fault signal occurs, the optional automatic switch-off locks the fuel shut-off valve (1) and thereby stops the fuel supply to the injection pump – the engine switches off. Also, a fault in the electrical equipment can cause the engine to switch off.

If this occurs at a critical location, such as at a railroad crossing or intersection, an emergency start can be activated.

### Safety Notes:

#### **Danger when switching off the engine from the emergency operation mode.**

During the emergency operation mode, the engine can only be switched off with the starting key if the emergency start lever is first returned to its home position in a clockwise direction.

### Caution:

#### **Danger of later engine damage.**

The monitoring components (oil pressure, charge control and engine temperature) are deactivated in emergency operation.

- The oil level must be checked before the emergency operation phase.

## NOTICE

**If the emergency operation mode is used, the risk transfers to the operator (Neither SWEpac nor HATZ does accept liability in this case).**

- Immediately after the emergency operation phase, determine the cause of the fault.
- Immediately arrange for emergency start lever with a new lead seal from the authorized Hatz outlet.

OVERVIEW

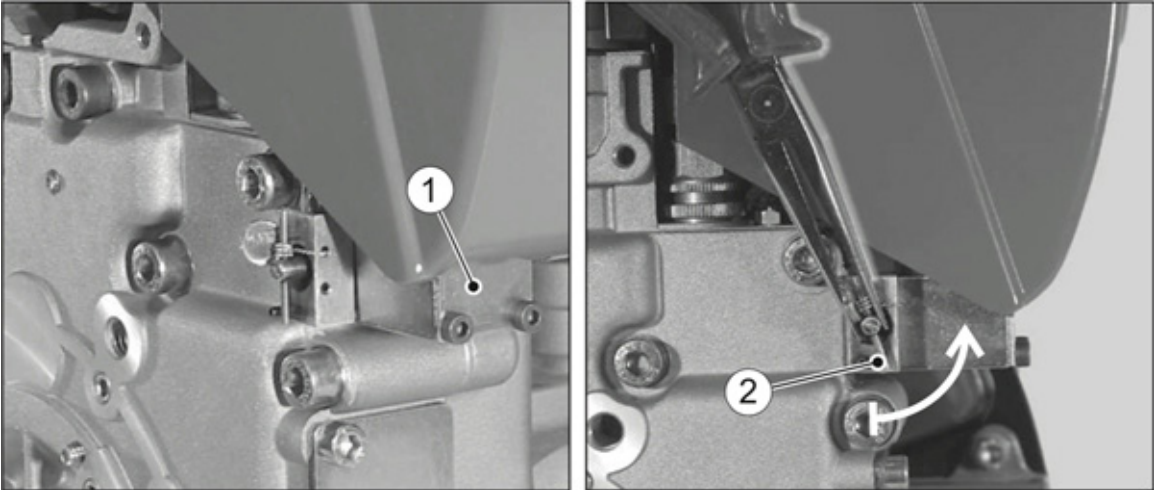

1	Fuel Shut-Off Valve (Optional)
2	Emergency Stop Lever

PROCEDURE

STEP	ACTIVITY
1	Using suitable pliers, turn the emergency start lever (2) counter clockwise by at least 90° (seal wire tears). The emergency start lever is now located in the start position, and the fuel shut-off valve (1) is mechanically unlocked.
2	Start the engine with the starter or recoil start
3	Turn the emergency start lever back to the stop in a clockwise direction. Otherwise, it will not be possible to switch off the machine using the starting key.

SWITCHING OFF THE ENGINE (MECHANICALLY)

NOTICE

	Engines with a blocked lower idle speed cannot be switched off with the speed control lever. In this case, the engine is switched off with the stop lever or starting key, depending on how the engine is equipped.
--	---

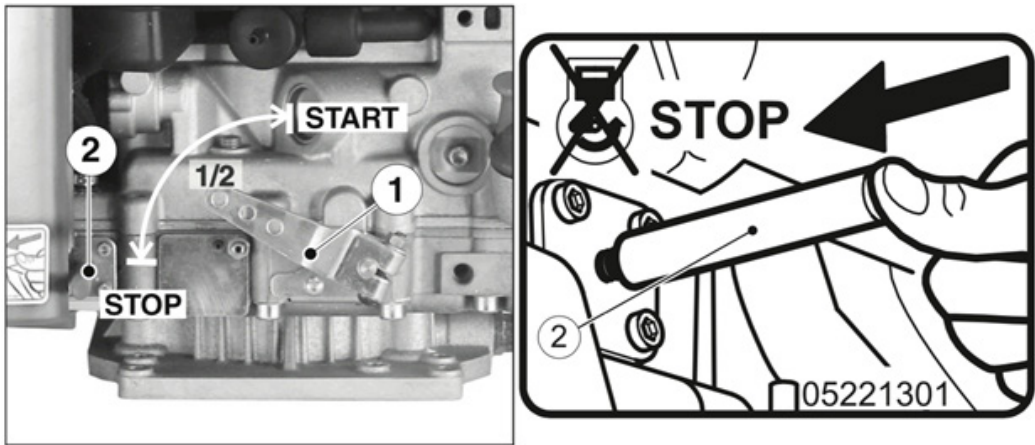

1	Speed Control Lever
2	Stop Pin (Optional)

**PROCEDURE**

STEP	ACTIVITY
------	----------

**Speed Control Lever**

1	Push the speed control lever (1) all the way to the "STOP" position. The engine switches off.
---	---

**Stop Pin**

1	Press and hold the stop pin (2) until the engine switches off.
2	Release the stop pin and ensure that it returns to its original position.

**Operation**

Before operating the machine, check for functioning of Push to Forward (Deadman's Handle),, parking brakes and other controls. Make sure that the machine moves forward, when the push-stop is pushed.

**1. Forward operation:**

Move the forward /reverse handle(1) forwards.

**2. Reverse operation:**

Move the forward/reverse handle (1) backwards.

**3. Vibration on:**

Move the vibration lever (2) forward.

**4. Vibration off:**

Move the vibration lever (2) to position 0.

**5. Self-driven forward**

The reversing machine will move forward automatically when the operator push the Push to Forward lever (3). In order to ensure the operator's security.

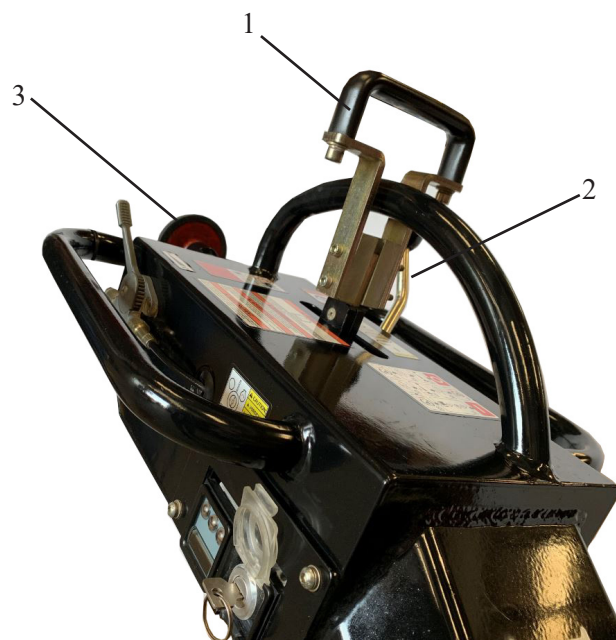

Operating Handle RDH760 with Lombardini Engine

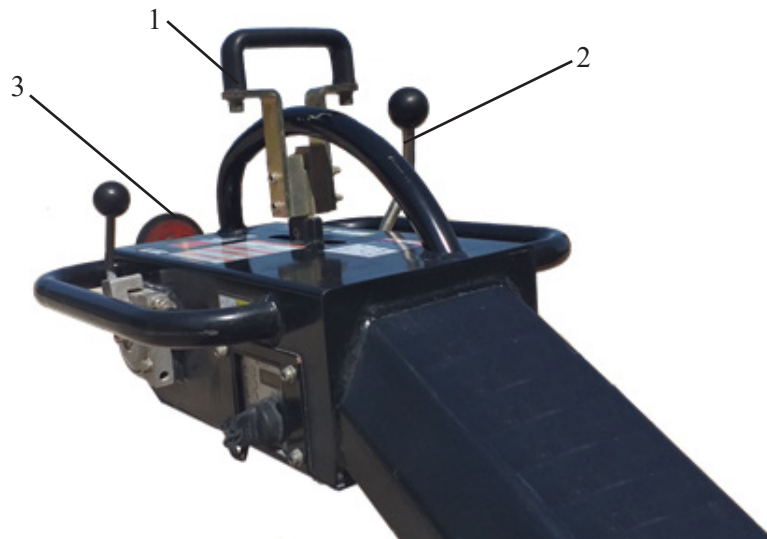

**Operating Handle RDH760 with HATZ Engine**

### **Operating near edger**

At least 2/3 of the drum should be on a surface with full bearing strength when operating along edger.

### **Operating on slope**

Always take special care to avoid the risk of personal injury or damage to the machine when operating on slopes or hills.

Always drive the machine straight up and down. Never drive the machine sideways.

Never leave the machine when the engine is running.

The maximum slope of the machine in operation is 19°.

### **Parking brake**

The parking brake is used to ensure that the machine will not roll when not in use.

ALWAYS park the machine on the most level ground.

1. Use the parking brake.
2. Turn off the engine and pull out the ignition key.

### **Lifting**

Before lifting the machine, ALWAYS check that the shock absorbers, safety straps and protective frame are correctly attached and not damaged. Lock the handle in the transport position.

1. NEVER tow the machine.
2. ONLY use steel ropes or chains for lifting.
3. Make sure that the ropes or chains must have enough lifting capacity to hold the machine (see the information on the machine plate for weight).
4. Lift the machine ONLY by the hook on the frame.
5. DO NOT stand or walk under a lifted machine.



## MAINTENANCE

### Periodic Maintenance Schedule

The below chart list basic machine and engine maintenance. Refer to engine Operation Manual for additional information on engine maintenance. A copy of the engine Operation Manual was supplied with the machine when it was shipped.

	Daily	Every 20 hours	Every 300 hours	Every 500 hours	Every 1200 hours	Every 3000 hours
Check fuel level.	X					
Check engine oil level.	X					
Inspect air filter. Replace as needed.	X					
Check the hydraulic fluid level	X					
Check the scrapers	X					
Check the water in sprinkler system	X					
Check external hardware.	X					
Check that all bolted joints are tightened	X					
Replace the engine oil			X			
Replace the oil filter		X				
Replace the air filter		X				
Check and adjust valve clearance		X				
Check the bolts connection		X				
Change the engine oil			X			
Change the oil filter			X			
Change the air filter			X			
Check and adjust valve clearance			X			
Check and clean cooling system			X			
Change the fuel filter.				X		
Change the hydraulic oil and filter				X		
Change the oil in the eccentric element			X			
Clean/Replace the air filter				X		

**Scraper**

1. Check the scraper and replace them as needed.
2. Clean the scraper daily after use and remove the dirt, mud from it

**Lubrication**

The long life and successful operation of any part of machine depends on regular and thorough lubrication. Before using the machine, always check the oil level and condition. Always use proper oil with recommended type and grade.

DO NOT mix different types of oil in eccentric element and DO NOT over fill the oil. Damage to the machine may occur if oils are mixed or overfilled. See Technical Data for oil quantity and type.

**Air Cleaner**

Maintaining a clean engine will extend engine life. Keep air filter clean at all times. Clean air filter using the recommended solvent daily. See engine manual for proper cleaning procedure. Let the filter dry before reinstalling.

**WARNING**

NEVER use gasoline or other types of low flash point solvents for cleaning the air cleaner. A fire or explosion could result.

**Hydraulic System**

1. If particles found in the hydraulic filter element, Change the hydraulic oil and clean all the components of the hydraulic oil system.
2. NEVER use any damaged component.
3. NEVER reuse the used hydraulic oil.
4. Relieve the hydraulic pressure before operating the machine.

**Transporting**

Before transporting the machine:

1. ALWAYS turn off the engine and pull out the key from the machine.
2. Use only the front and rear tie downs to secure the machine, decals indicate in the machine.

**Storing**

If the machine is to be stored for more than 30 days:

1. Drain the fuel tank and water tank.
2. Open the water valve and drain water from the sprinkling system.
3. Cover the machine.
4. Place the machine in a dry and protected area.
5. Change the oil.
6. Put a little oil into the engine cylinder.
7. Remove the battery from the machine.

**Troubleshooting**

<b>SYMPTON</b>	<b>POSSIBLE CAUSES</b>	<b>SOLUTION</b>
Engine does not start	Engine problem.	Consult engine manufacturer's service manual.
Engine stops by itself	Fuel tank empty. Fuel filter plugged. Fuel lines broken or loose.	Fill fuel tank. Replace Fuel filter. Replace lines.
Machine does not start	Sheared key.	Check and repair it.
No vibration	Vibration Valve damaged.  Exciter motor or bearing damaged. Exciter Pump damaged.	Check and replace it if necessary. Check the motor and bearing. Check exciter system pressure, and replace the pump if necessary.
No travel or Travel only in one direction	Engine speed too low. Control cable loose or broken.  Drive motor damaged. Drive pump damaged. Control lever pin sheared.	Run engine at full throttle. Check and repair the cable, replace it if necessary. Replace the motor. Replace the pump. Check and repair it.



## EC-declaration of conformity

### Manufacturer

**Swepac AB  
Blockvägen 3  
34132 Ljungby**

1. Category: Double drum vibratory roller
2. Type: RDH 760 L / RDH 760 Z
3. Engine power:
  - 8.1 kW Lombardini Kohler 15 LD 440
  - 7.5 kW Hatz 1B40

The product complies with the following directives:

2006 / 42 / EG

2000 / 14 / EG

2004 / 108 / EG

EN 500-1

EN 500-4

Technical documentation held by:  
Swepac AB, Blockvägen 3 SE-34132 Ljungby  
Hans Holmlund / Product Manager

**SWEPAC**

**SWEPAC AB**

Address **Blockvägen 3, 341 32 Ljungby, Sweden**, tel. **+46 (0)372-156 00**, fax **+46 (0)372-837 41**, E-mail **mail@swepac.se**,  
Internet **www.swepac.se**